

ITEM NO.	PART NUMBER	DESCRIPTION	QTY.
1	ANT-103-0006	VERTICAL CORNER PIECE	4
2	ANT-103-0007	HORIZONTAL CROSSBEAM	16
3	14-1012-103-0001	END PANEL	2
4	HFH-M10-20	THREADED PEM STUD	4
5	FH-M6-15	THREADED PEM STUD	2
6	14-1012-103-0003	SUPPORT BRACKET	4
7	ARB-M10-020-S	RIVET BUSH	4
8	14-1012-103-0002	STRUT SUPPORT LG	12
9	PEM CLS-M6-1 ---N		12
10	ANT-103-0002	VERTICAL STRUT	4
11	ANT-103-0001	HORIZONTAL STRUT	20
12	ANT-103-0003	VERTICAL STRUT 2	2
13	ANT-103-0005	BUSBAR 2012	1
14	ANT-103-0004	BUSBAR 500	1
15	INS SPACER M4-15-SW14	INSULATED SPACER M4-15-SW14	2
16	M6 CAGE NUT	M6 CAGE NUT	84
17	ANT-103-1013	BASE	1
18	PEM CLS-M4-1 ---N		2
19	FHS-M6-15	THREADED PEM STUD	2
20	ANT-103-1012	TOP PANEL	1
21	ANT-103-1010	RH HINGE BRACKET	1
22	ANT-103-1011	LH HINGE BRACKET	1
23	ANT-103-1009	DOOR	1
24	ANT-103-1014	PERSPEX PLATE	1
25	8mm x 1mm x 430mm Double Sided Foam	8mm X 1mm DOUBLE SIDED FOAM	2
26	M6 INTERNAL STAR WASHER	DIN 125	4
27	ø4 - 53 (GRIP 3.2-4.8)	ALUM POP RIVET TAP/D	6
28	M4x20 POZI PAN HD SCREW ZP	ISO 3506 STAINLESS	2
29	M6 HEX NUT	DIN934	4
30	4 X 2 X 700mm TIMBER	4" X 2" TIMBER SPACER	2
31	M6x16 POZI PAN HD SCREW ZP	ISO 3506 STAINLESS	3
32	M6 TENSILOCK NUT	HEX NUT SERRATED FLANGE BZP	23
33	M5 MUDGUARD WASHER	DIN 9021	6
34	M6x12 POZI PAN HD SCREW ZP	ISO 3506 STAINLESS	116
35	M4X6mm CSK POZI SCREW	M4 X 6mm POZI POZI SCREW	4
36	M5 HEX NUT	DIN934	6
37	M5X20mm CSK POZI SCREW	M5 X 20 CSK POZI SCREW	6
38	NO.2 30mm LONG WOOD SCREW	NO2 X 30 WOOD SCREW	4
39	M6 FLAT WASHER	DIN 125	2
40	M10 HEX NUT	DIN934	4

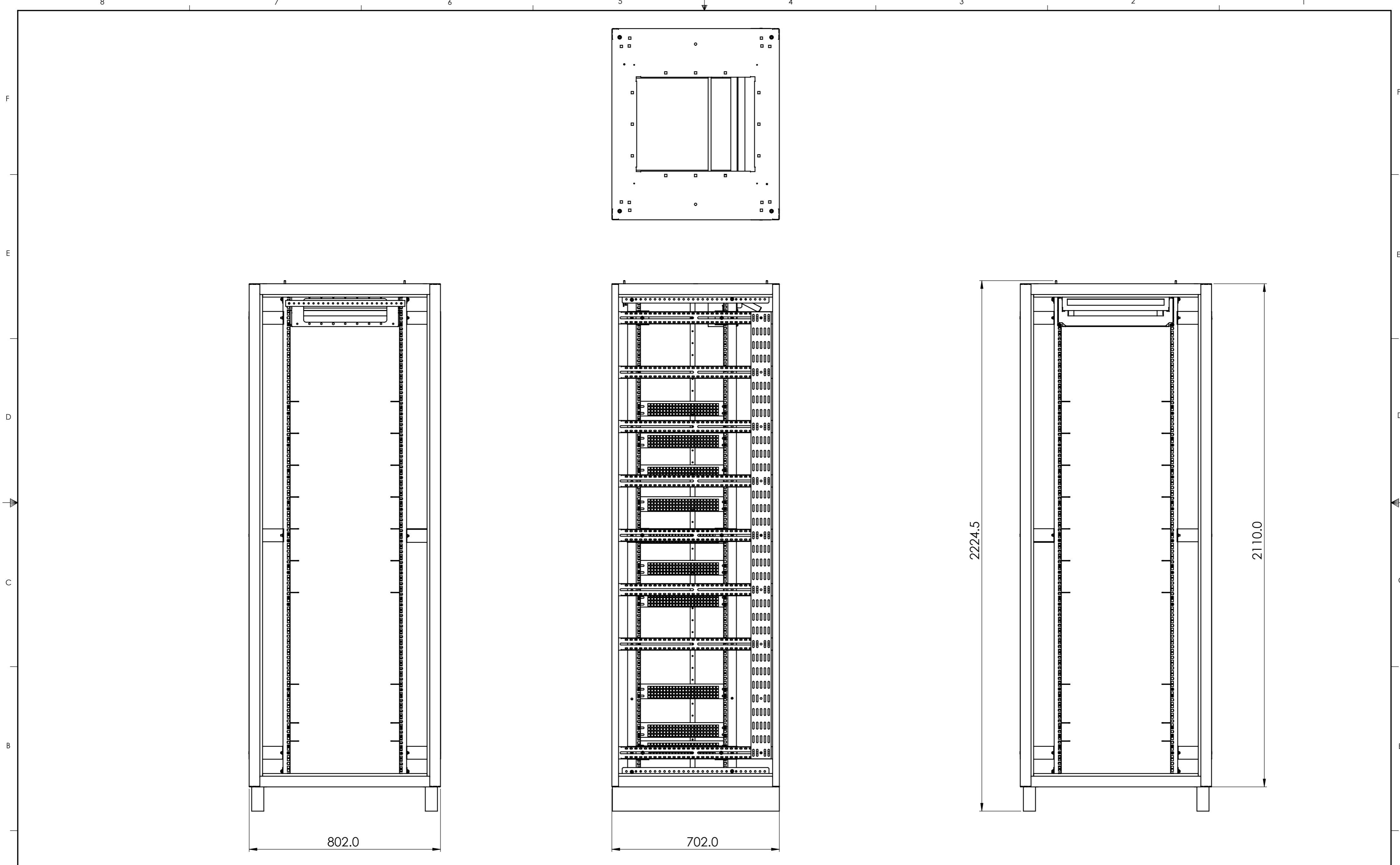

ZONE	REV.	DESCRIPTION	DATE	APPROVED

 <b>Q5Q54 REV A</b> <small>PROPRIETARY AND CONFIDENTIAL</small> <small>THE INFORMATION CONTAINED IN THIS DRAWING IS THE SOLE PROPERTY OF KELTECH ENGINEERING LTD. ANY REPRODUCTION IN PART OR AS A WHOLE WITHOUT THE WRITTEN PERMISSION OF KELTECH ENGINEERING LTD. IS PROHIBITED.</small>	VEE SIZE USED:		UNLESS OTHERWISE SPECIFIED:	NAME	DATE	FINISH	N/A	
	BEND ALLOWANCE:		DIMENSIONS ARE IN MM TOLERANCES: ANGULAR: BEND ± 0.5 ONE PLACE DECIMAL ±0.3 TWO PLACE DECIMAL ±0.1	DRAWN	RS	04/02/2014	TITLE:	
	TOP LEVEL ASSEMBLY:	14-1012-RM	MATERIAL	CHECKED			45U 19 INCH 800MM RACK	
	CUSTOMER:	ANT COMM	THICKNESS	ENG APPR.			DWG. NO.	REV
		mm	Q.A.			14-1012-RM	0	
		DO NOT SCALE DRAWING	COMMENTS:			SCALE: 1:20	WEIGHT : 82.29kg	SHEET 1 OF 2



	VEE SIZE USED:		UNLESS OTHERWISE SPECIFIED:	NAME	DATE	FINISH N/A
	BEND ALLOWANCE:			DRAWN	RS	
<b>Q5Q54 REV A</b> <small>PROPRIETARY AND CONFIDENTIAL</small> <small>THE INFORMATION CONTAINED IN THIS DRAWING IS THE SOLE PROPERTY OF KELTECH ENGINEERING LTD. ANY REPRODUCTION IN PART OR AS A WHOLE WITHOUT THE WRITTEN PERMISSION OF KELTECH ENGINEERING LTD. IS PROHIBITED.</small>	TOP LEVEL ASSEMBLY:	<b>14-1012-RM</b>	<small>DIMENSIONS ARE IN MM</small> <small>TOLERANCES:</small> <small>ANGULAR: BEND ± 0.5</small> <small>ONE PLACE DECIMAL ±0.3</small> <small>TWO PLACE DECIMAL ±0.1</small>	CHECKED		TITLE: <b>45U 19 INCH 800MM RACK</b>
	CUSTOMER:	<b>ANT COMM</b>		ENG APPR.		
			MATERIAL	MFG APPR.		DWG. NO. <b>14-1012-RM</b>
			THICKNESS mm	Q.A.		REV <b>0</b>
			DO NOT SCALE DRAWING	COMMENTS:		SCALE: 1:20   WEIGHT : 82.29kg   SHEET 2 OF 2

ZONE	REV.	DESCRIPTION	DATE	APPROVED

REVISIONS